



ROAD LEGAL  
LED BULB KIT

E8 10R-0617590

HE E8 0105

**H11**  
Base Type

**ROAD LEGAL** ECE R37

LOW BEAM HIGH BEAM & FOG APPLICATIONS

## Product Dimensions

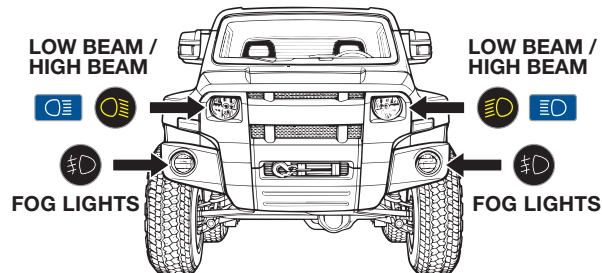
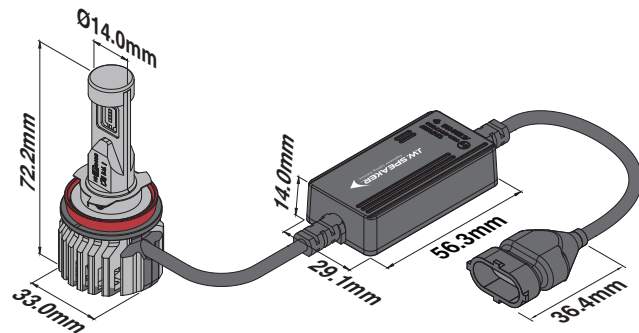

If you are unsure whether this product is suitable for your vehicle, please consult a qualified auto electrician or mechanic.

# ECELEDr

### SPECIFICATIONS

Voltage: 12V DC  
Light Output: 1350 raw lumens per bulb  
Colour: 5700K white light  
Power: 15W per bulb  
Operating Temp: -45°/+85°C  
IP Rating: IP65  
ECE Approvals: R10, R37  
Warranty: 2 years

### CONTENTS

2 x LED headlight bulbs

Please check  
vehicle specific  
instruction list



[www.invisionsales.com](http://www.invisionsales.com)

Part No: **960011**

**H11 ECELEDr** Road Legal  
LED Bulb Kit - 12V 5700K

Distributed by Invision Sales Pty Ltd  
[www.invisionsales.com](http://www.invisionsales.com)



1

Make sure the vehicle and headlights are turned off before proceeding with the LED bulb upgrade.

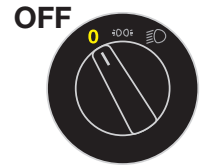

5

With the cable exiting the bulb aiming **downwards**, insert the LED bulb into the headlight.

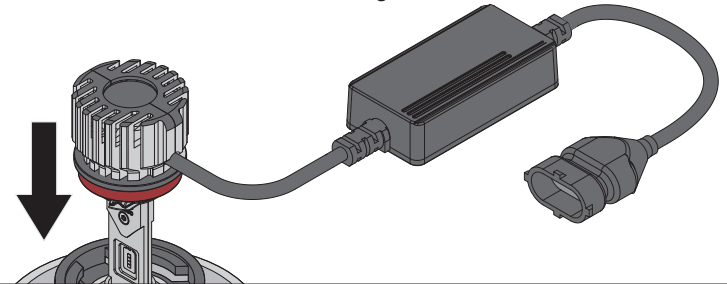

8

To avoid damage, the power module must be secured to either;

a) A solid structure behind the headlight.

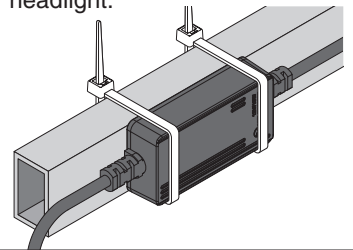

b) Within the headlight itself.

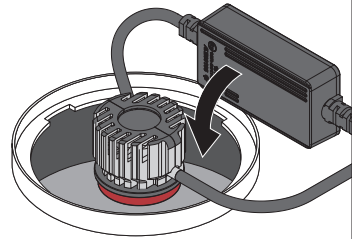

2

Disconnect the plug from the original bulb.

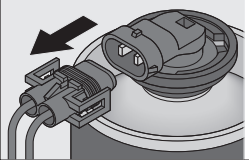

3

Twist the bulb to unlock it from the headlight housing.

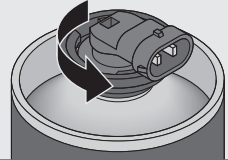

4

Gently remove the original bulb.

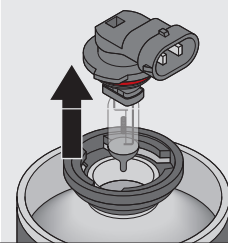

6

Twist the bulb to lock it into place.

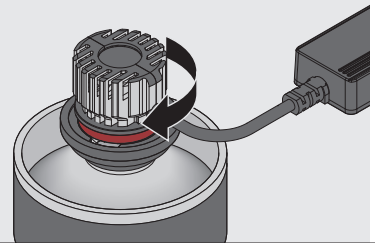

7

Connect the LED bulb plug to the original vehicle plug.

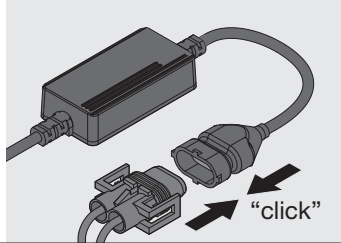

9

Turn the vehicle and headlights on to test the new LED bulbs. A successful installation will mean the bulbs function without any vehicle warnings. If warnings do appear, a CANbus module will be required for successful operation. (PN: 990011CB)

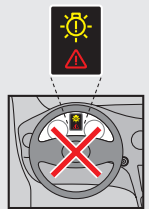
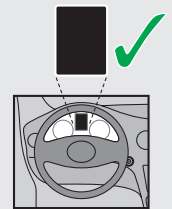

## TROUBLESHOOTING GUIDE

Please follow the steps below to identify the issue before requesting warranty service.

 | Flickering

Install a compatible CANbus decoder to resolve the issue.

 | Light Not Working

Ensure the product is installed correctly. If the light still does not work, disconnect the power line and contact us for warranty service.

 | Abnormal Lighting

Install a compatible CANbus decoder to resolve the issue.

 | Intermittent Shutdown

If the light works initially but turns off after a while and works again after restarting the power, this may be due to overheating. Replace the dust cover with one that allows better heat dissipation.

---

## IMPORTANT NOTICE

The following situations are not covered under warranty:

### 1. CANbus Issues

Some vehicles may experience flickering or errors after replacing halogen bulbs with LED bulbs. A suitable CANbus decoder is required.

### 2. Damage Caused by Improper Use

Including damaged LED chips / broken wires / unauthorized modification or repair.

### 3. Installation Limitations

Incompatibility due to limited space or unsuitable installation positions in certain vehicles.

### 4. Force Majeure

Damage caused by natural disasters such as earthquakes, floods, etc.

---

## WARNING

Failure to use this LED replacement light in accordance with the provided instructions and your vehicle's guidelines may result in:

- Electrical system malfunctions
- Reduced operational safety
- Potential traffic hazards

## GUIDA ALLA RISOLUZIONE DEI PROBLEMI

Seguire i passaggi riportati di seguito per identificare il problema prima di richiedere assistenza in garanzia.

 | Sfarfallio della luce

Installare un decoder CANbus compatibile per risolvere il problema.

 | Luce non funzionante

Assicurarsi che il prodotto sia installato correttamente. Se la luce continua a non funzionare, scollegare l'alimentazione e contattarci per l'assistenza in garanzia.

 | Illuminazione anomala

Installare un decoder CANbus compatibile per risolvere il problema.

 | Spegnimento intermittente

Se la luce funziona inizialmente ma si spegne dopo un po' e torna a funzionare dopo aver riavviato l'alimentazione, il problema potrebbe essere causato dal surriscaldamento. Sostituire il copripolvere con uno che permetta una migliore dissipazione del calore.

---

## AVVISO IMPORTANTE

Le seguenti situazioni non sono coperte da garanzia:

### 1. Problemi CANbus

Alcuni veicoli potrebbero presentare sfarfallii o errori dopo la sostituzione delle lampade alogene con lampade LED. È necessario utilizzare un decoder CANbus adeguato.

### 2. Danni causati da uso improprio

Inclusi chip LED danneggiati, fili rotti, modifiche o riparazioni non autorizzate.

### 3. Limitazioni di installazione

Incompatibilità dovuta a spazio limitato o posizioni di installazione non idonee su determinati veicoli.

### 4. Forza maggiore

Danni causati da calamità naturali come terremoti, alluvioni, ecc.

---

## ATTENZIONE

Il mancato utilizzo di questa lampada LED sostitutiva in conformità alle istruzioni fornite e alle linee guida del veicolo può causare:

- Malfunzionamenti del sistema elettrico
- Riduzione della sicurezza operativa
- Potenziali pericoli per la circolazione stradale

## GUÍA DE SOLUCIÓN DE PROBLEMAS

Siga los pasos a continuación para identificar el problema antes de solicitar el servicio de garantía.

 | Parpadeo

Instale un decodificador CANbus compatible para resolver el problema.

 | La luz no enciende

Asegúrese de que el producto esté instalado correctamente. Si la luz aún no funciona, desconecte la alimentación y contacte con el servicio de atención al cliente para la garantía.

 | Iluminación anormal

Instale un decodificador CANbus compatible para resolver el problema.

 | Apagado intermitente

Si la luz funciona al principio pero se apaga después de un tiempo y vuelve a funcionar tras reiniciar la alimentación, puede deberse a sobrecalentamiento. Reemplace la tapa antipolvo por una que permita una mejor disipación del calor.

---

## AVISO IMPORTANTE

Las siguientes situaciones no están cubiertas por la garantía:

### 1. Problemas de CANbus

Algunos vehículos pueden presentar parpadeo o errores después de reemplazar bombillas halógenas por LED. Se requiere un decodificador CANbus compatible.

### 2. Daños por uso indebido

Incluyendo: Chips LED dañados / Cables rotos / Modificaciones o reparaciones no autorizadas

### 3. Limitaciones de instalación

Incompatibilidad debido a espacio reducido o posiciones de instalación inadecuadas.

### 4. Fuerza mayor

Daños causados por desastres naturales como terremotos, inundaciones, etc.

---

## ADVERTENCIA

El uso incorrecto de esta luz LED de reemplazo, sin seguir las instrucciones del producto y del vehículo, puede provocar:

- Fallos en el sistema eléctrico
- Reducción de la seguridad operativa
- Riesgos potenciales en la conducción